

How many years would it take to replace your collection?
 Safe-guard your valuable specimens
PERMANENT SPECIMEN PRESERVATION

with *Lane* **ZOOLOGY AND ORNITHOLOGY**
SPECIMEN CABINETS

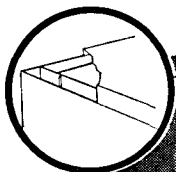

Double Wall Construction

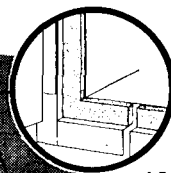
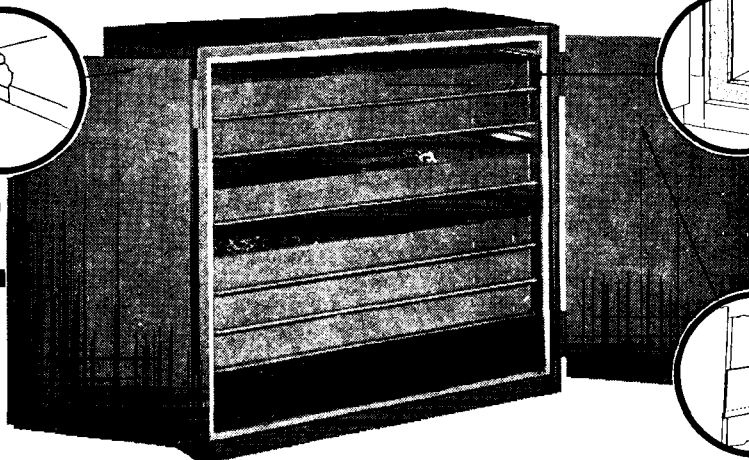

Pest-Proof and Air Tight Seal

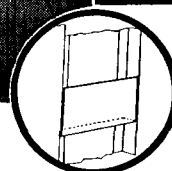

Fumigant Compartment

- Double Wall Construction
- Pest-Proof and Air Tight Seal
- Double Panel Door
- Lift-Off Safe Type Hinge
- Fumigant Compartment
- 3-Point Locking Mechanism
- Front and Back Air Tight Seals
- Specimen Trays of Aluminum and Masonite. Lightweight, sturdy and easy to handle.

Skin Case #201 (illustrated)
 Holds large trays for larger specimens.

Skin Case # 202 (not illustrated)
 Divided for half-size trays for smaller specimens.

FOR ILLUSTRATED BROCHURE, WRITE

Lane

SCIENCE EQUIPMENT CO.
 225 WEST 34th Street New York, NY 10122

Lane Science Equipment Co. Dept. D
 225 WEST 34th Street, New York, NY 10122

Please send complete details on Lane Zoology and Ornithology Specimen Cabinets to:

Name _____ Title _____

Institution _____

Address _____

City _____ Zone _____ State _____

Breeding Biology of the Adélie Penguin

by David G. Ainley, Robert E. LeResche, and William J. L. Sladen

The Adélie penguin is probably the best-known large seabird. Based on fifteen years of fieldwork with a particular population of Adélie penguins at Cape Crozier, Ross Island, Antarctica, this first long-term study of a known-age population greatly increases our understanding of the population ecology of vertebrates, and the effects of age, experience, and environment on their behavior. \$27.50, illustrated

Vulture Biology and Management

Edited by Sanford R. Wilbur and Jerome A. Jackson

This volume includes the best and most recent research on vultures. Alternately persecuted and revered, this uniquely adapted group of birds now faces a modern danger—increasing human populations and changes in land use which threaten their habitats and food sources. This book unites thirty-two contributions by thirty-eight vulture authorities. Both Old World and New World vultures are covered, and an exhaustive bibliography is included. \$45.00, illustrated

Nature Through Tropical Windows

by Alexander Skutch, Illustrated by Dana Gardner

Skutch, winner of the John Burroughs Medal for his book *A Naturalist on a Tropical Farm*, is known the world over as an ornithologist who has searched remote forests for well-hidden nests of exotic birds. But birds of better-known families build nests in front of the windows of his home, permitting him more intimate studies than can often be made of elusive woodland species. Here, chapters about these birds alternate with chapters of wider scope. \$19.95, illustrated

Birds of Southern California's Deep Canyon

by Wesley W. Weathers

Rugged and starkly beautiful, Deep Canyon links one of North America's hottest, driest regions, the Colorado Desert, with the cool forests of the Peninsular Mountain Range. Weathers presents comprehensive accounts of the abundance, diversity, and natural history of birdlife along this vast slope. He offers a wealth of new information on bird species diversity and habitat and temporal distributions, and raises numerous issues for further research. \$35.00, illustrated

Available at bookstores or order from

University of
California Press
Berkeley 94720

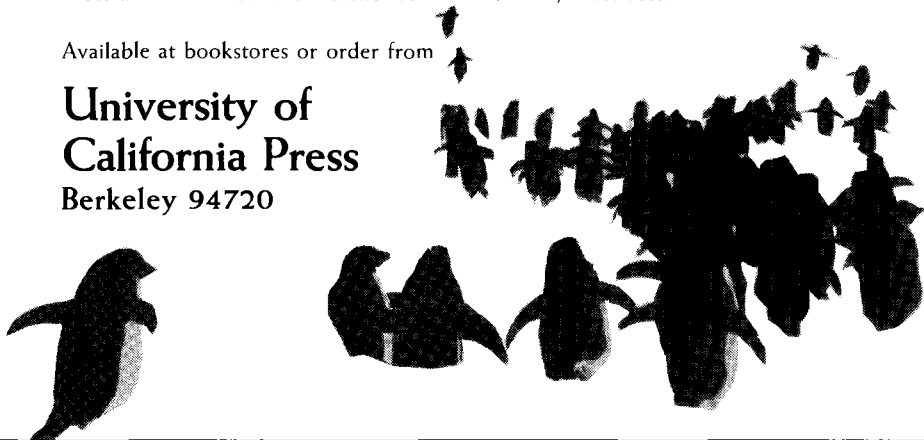

AOU

JUST PUBLISHED

ORNITHOLOGICAL MONOGRAPHS No. 31

The Native Forest Birds of Guam, by J. Mark Jenkins. x + 61 pp., color frontispiece, VI color plates, 24 text figures. 1983. Price \$9.00 (\$7.00 to A.O.U. members). Order from Frank R. Moore, Assistant to the Treasurer, A.O.U., Department of Biology, University of Southern Mississippi, Southern Station Box 5018, Hattiesburg, Mississippi 39406, U.S.A. All orders must be prepaid and include a \$0.50 handling charge.

The Auk

A Quarterly Journal of Ornithology

EDITOR

JOHN A. WIENS

COPY EDITOR

JEAN FERNER

ASSOCIATE EDITORS

WALTER BOCK, HERBERT W. KALE II, WILLIAM E. SOUTHERN

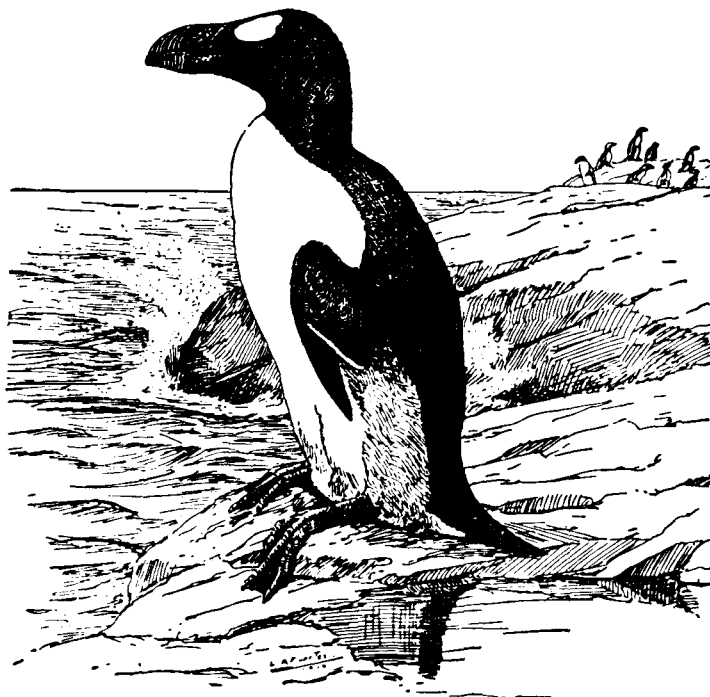

VOLUME 100

PUBLISHED BY

THE AMERICAN ORNITHOLOGISTS' UNION

1983

CONTENTS OF VOLUME 100

NUMBER 1

FRUGIVORY AND POLYGAMY IN BIRDS OF PARADISE. <i>Bruce Beehler</i>	1
SPACING OUT AT MONO LAKE: BREEDING SUCCESS, NEST DENSITY, AND PREDATION IN THE SNOWY PLOVER. <i>Gary W. Page, Lynne E. Stenzel, David W. Winkler, and Christopher W. Swarth</i>	13
INTRASEASONAL REPRODUCTIVE COSTS FOR THE HOUSE SPARROW (<i>Passer domesticus</i>). <i>W. Bruce McGillivray</i>	25
GENIC VARIATION, SYSTEMATIC, AND BIOGEOGRAPHIC RELATIONSHIPS OF SOME GALLIFORM BIRDS. <i>R. J. Gutiérrez, Robert M. Zink, and Suh Y. Yang</i>	33
NEST ATTENDANCE OF PARENT BIRDS IN THE PAINTED SNIPE (<i>Rostratula benghalensis</i>). <i>Shigemoto Komeda</i>	48
ENDOCRINE RESPONSES TO INCLEMENT WEATHER IN NATURALLY BREEDING POPULATIONS OF WHITE-CROWNED SPARROWS (<i>Zonotrichia leucophrys pugetensis</i>). <i>John C. Wingfield, Michael C. Moore, and Donald S. Farner</i>	56
SEXUAL DIFFERENCES IN THE BEHAVIOR OF ADULT GREAT BLACK-BACKED GULLS (<i>Larus marinus</i>) DURING THE PRE- AND POST-HATCH PERIODS. <i>Ronald G. Butler and Saskia Janes-Butler</i>	63
NEST MICROCLIMATE, WATER-VAPOR CONDUCTANCE, AND WATER LOSS IN HERON AND TERN EGGS. <i>Carol Masters Vleck, David Vleck, Hermann Rahn, and Charles V. Paganelli</i>	76
HUNTING BEHAVIOR, PREY SELECTION, AND ENERGETICS OF SNAIL KITES IN GUYANA: CONSUMER CHOICE BY A SPECIALIST. <i>Steven R. Beissinger</i>	84
MOLLUSK PREDATION BY SNAIL KITES IN COLOMBIA. <i>Noel F. R. Snyder and Herbert W. Kale II</i>	93
BEHAVIOR, MORPHOLOGY, AND SYSTEMATICS OF <i>Sirytes sibilator</i> (TYRANNIDAE). <i>Wesley E. Lanyon and John W. Fitzpatrick</i>	98
THE FUNCTION OF SINGING IN FEMALE BLACK-HEADED GROSBEAKS (<i>Pheucticus melanocephalus</i>): FAMILY-GROUP MAINTENANCE. <i>Gary Ritchison</i>	105
NOTES ON THE BEHAVIOR OF THE COSTA RICAN SHARPBILL (<i>Oxyruncus cristatus frater</i>). <i>F. Gary Stiles and Bret Whitney</i>	117
EVIDENCE FOR A POLYPHYLETIC ORIGIN OF THE PICIFORMES. <i>Storrs L. Olson</i>	126
MONOPHYLY OF THE PICIFORMES: A REPLY TO OLSON. <i>Robert J. Raikow and Joel Cracraft</i>	134
WHY DO BROWN-HEADED COWBIRDS PERFORM THE HEAD-DOWN DISPLAY? <i>Thomas W. Scott and Judith M. Grumstrup-Scott</i>	139
TIME AND ENERGY BUDGETS OF THE MOCKINGBIRD (<i>Mimus polyglottos</i>) DURING THE BREEDING SEASON. <i>Douglas W. Biedenweg</i>	149
HARLAN'S HAWK (<i>Buteo jamaicensis harlani</i>): A VALID SUBSPECIES. <i>David P. Mindell</i>	161
ADAPTATIONS OF THE GRAY CATBIRD <i>Dumetella carolinensis</i> TO LONG DISTANCE MIGRATION: ENERGY STORES AND SUBSTRATE CONCENTRATIONS IN PLASMA. <i>Richard L. Marsh</i>	170
VARIABILITY IN ISLAND POPULATIONS OF THE HOUSE FINCH. <i>Dennis M. Power</i>	180
IN MEMORIAM: EUGENE EISENMANN. <i>John Bull and Dean Amadon</i>	188
SHORT COMMUNICATIONS	
Helping at the Nest in Darwin's Finches as Misdirected Parental Care. <i>Trevor Price, Stephen Millington, and Peter Grant</i>	192
Avoidance of Venomous Sea Snakes by Naive Herons and Egrets. <i>Gloria Sullivan Caldwell and Roberta Wolff Rubinoff</i> ...	195
Winter Distribution of Subspecies of Clapper Rails (<i>Rallus longirostris</i>) in Florida with Evidence for Long-distance and Overland Movements. <i>Robert L. Crawford, Storrs L. Olson, and Walter Kingsley Taylor</i>	198
Assortative Mating by Brant. <i>Kenneth F. Abraham, C. Davison Ankney, and H. Boyd</i>	201
Natal and Juvenal Plumages of the Blue-and-White Swallow (<i>Notiochelidon cyanoleuca</i>). <i>Keith A. Arnold, Eva Jolene Boyd, and Charles T. Collins</i>	203
Postnuptial and Postjuvenal Molts of Red-winged Blackbirds in Cass County, North Dakota. <i>George M. Linz, Susan B. Bolin, and J. Frank Cassel</i>	206
Female-Female Pairs and Polygynous Associations in a Québec Ring-billed Gull Colony. <i>Marie-Christine Lagrenade and Pierre Mousseau</i>	210
A Record of the Siberian Flycatcher (<i>Muscicapa sibirica</i>) from Bermuda: an Extreme Extra-limital Vagrant. <i>David B. Wingate</i>	212
Incidental Ingestion of Cassin's Auklets by Humpback Whales. <i>William F. Dolphin and Daniel McSweeney</i>	214
Does Sex Ratio Vary with Egg Sequence in Lesser Snow Geese? <i>F. Cooke and R. Harmsen</i>	215
Effects of Intraspecific Piracy on Breeding Ring-billed Gulls. <i>Sue F. Elston and William E. Southern</i>	217

First Record of the South American Pochard in Central Brazil. <i>Paulo de Tarso Zuquim Antas and Susana de Moura Lara Resende</i>	220
The Magellanic Penguin (<i>Spheniscus magellanicus</i>): Sexing Adults by Discriminant Analysis of Morphometric Characters. <i>José A. Scolaro, Martin A. Hall, and Isaías M. Ximénez</i>	221
COMMENTARIES	
On Sightings and Specimens. <i>F. Gary Stiles</i>	225
Do Darwin's Finches Lay Small Eggs? <i>D. M. Scott and C. Davison Ankney</i>	226
The Relative Size of Darwin's Finch Eggs. <i>P. R. Grant</i>	228
Further Notes on Variation in Leach's Storm-Petrel. <i>David G. Ainley</i>	230
What Systematic Method Will Ornithology Adopt?—A Reply to Olson (1982). <i>Joel Cracraft</i>	233
Evidence for Hybrid Murre Reconsidered. <i>Ronald Sluys</i>	236
Evidence for Hybrid Murre Reconsidered—A Comment. <i>D. K. Cairns</i>	238
REVIEWS. Edited by <i>William E. Southern</i>	239
BREWSTER AWARD, 1982	268
NOTES AND NEWS	24, 32, 55, 125, 138, 148, 169

NUMBER 2

THE PALLID FALCON <i>Falco kreyenborgi</i> IS A COLOR PHASE OF THE AUSTRAL PEREGRINE FALCON (<i>Falco peregrinus cassini</i>). <i>David H. Ellis and Cesar Peres Garat</i>	269
POPULATION STUDIES OF THE POLYANDROUS SPOTTED SANDPIPER. <i>Lewis W. Oring, David B. Lank, and Stephen J. Maxson</i>	272
FRUITS AND THE ECOLOGY OF RESPLENDENT QUETZALS. <i>Nathaniel T. Wheelwright</i>	286
FORCED COPULATION IN CAPTIVE MALLARDS III. SPERM COMPETITION. <i>Kimberly M. Cheng, Jeffrey T. Burns, and Frank McKinney</i>	302
SYSTEMATICS OF THE SOUTHERN FORMS OF <i>Selasphorus</i> (TROCHILIDAE). <i>F. Gary Stiles</i>	311
CLUTCH SIZE IN THE EASTERN KINGBIRD: FACTORS AFFECTING NESTLING SURVIVAL. <i>Michael T. Murphy</i>	326
TEMPORAL CHANGES IN HABITAT SELECTION AND NEST SPACING IN A COLONY OF ROSS' AND LESSER SNOW GEESE. <i>M. Robert McLandress</i>	335
WEIGHTS, BREEDING, AND SURVIVAL IN EUROPEAN SPARROWHAWKS. <i>I. Newton, M. Marquiss, and A. Village</i>	344
CURRENT STATUS OF THE BROWN-HEADED COWBIRD IN THE SIERRA NATIONAL FOREST. <i>Jared Verner and Lyman V. Ritter</i>	355
PACIFIC COAST CASPIAN TERNS: DYNAMICS OF AN EXPANDING POPULATION. <i>Robert E. Gill, Jr. and L. Richard Mewaldt</i>	369
GEOGRAPHIC VARIATION IN HABITAT STRUCTURE OF THE BLACK-THROATED GREEN WARBLER (<i>Dendroica virens</i>). <i>Scott L. Collins</i>	382
SIZE AND LOCOMOTION IN TERATORNS (AVES: TERATORNITHIDAE). <i>Kenneth E. Campbell, Jr. and Eduardo P. Tonni</i>	390
REPRODUCTIVELY DEPENDENT SONG CYCLICITY IN MATED MALE MOCKINGBIRDS (<i>Mimus polyglottos</i>). <i>Cheryl A. Logan</i>	404
COMMUNICATION WITH SHARED SONG THEMES IN TUFTED TITMICE. <i>Donna J. Schroeder and R. Haven Wiley</i>	414
ENERGETICS AND GROWTH PATTERNS OF THREE TROPICAL BIRD SPECIES. <i>David M. Bryant and Christopher J. Hails</i>	425
THE STRUCTURE OF AERIAL DISPLAYS IN THREE SPECIES OF CALIDRIDINAE (SCOLOPACIDAE). <i>Edward H. Miller</i>	440
DIALECT DISCRIMINATION BY WHITE-CROWNED SPARROWS: REACTIONS TO NEAR AND DISTANT DIALECTS. <i>Diana F. Tomback, Daniel B. Thompson, and Myron Charles Baker</i>	452
GENERALIZATION OF AND EFFECTS OF PRE-EXPOSURE ON COLOR-AVOIDANCE LEARNING BY RED-WINGED BLACKBIRDS (<i>Agelaius phoeniceus</i>). <i>J. Russell Mason and Russell F. Reidinger, Jr.</i>	461
BROOD REDUCTION IN BLACK-LEGGED KITTIWAKES. <i>Barbara M. Braun and George L. Hunt, Jr.</i>	469
ASPECTS OF FOOD FINDING BY WINTERING BALD EAGLES. <i>Susan K. Knight and Richard L. Knight</i>	477
SHORT COMMUNICATIONS	
Mechanics of Steaming in Steamer-ducks. <i>Bradley C. Livezey and Philip S. Humphrey</i>	485
Records of Migrant Hawks from the North Atlantic Ocean. <i>Paul Kerlinger, Jeffrey D. Cherry, and Kevin D. Powers</i>	488
Co-occurring Groups of Wintering Birds in the Lowlands of Southern California. <i>Richard A. Bradley and David W. Bradley</i>	491
Chaffinch Imitates Canary Song Elements and Aspects of Organization. <i>P. J. B. Slater</i>	493
Opportunistic Foraging of Western Kingbirds on Aggregations of Tiger Beetles. <i>Thomas D. Schultz</i>	496

Homogeneity of Vegetational Cover around the Nest and Avoidance of Nest Predation in Mockingbirds. <i>William T. Joern and James F. Jackson</i>	497
Breeding Flight Display in the Female White-rumped Sandpiper (<i>Calidris fuscicollis</i>). <i>Brian J. McCaffery</i>	500
Myology and Histology of the Phalloid Organ of the Buffalo Weaver (<i>Bubalornis albirostris</i>). <i>Gregory Dean Bentz</i>	501
A New Subspecies of Henslow's Sparrow (<i>Ammodramus henslowii</i>). <i>Keith A. Arnold</i>	504
A Ground Nesting Wood Duck. <i>Phillip J. Mason and Julian L. Dusi</i>	506
REVIEWS. <i>Edited by William E. Southern</i>	507
CLARIFICATION: MONOPHYLY OF THE PICIFORMES	301
NOTES AND NEWS	325, 334, 403, 424

NUMBER 3

"REPLACEMENTS" OF LANDBIRD SPECIES ON SOCORRO ISLAND, MEXICO. <i>Joseph R. Jehl, Jr. and Kenneth C. Parkes</i>	551
IDENTIFICATION OF NATAL LOCALES OF PEREGRINE FALCONS (<i>Falco peregrinus</i>) BY TRACE-ELEMENT ANALYSIS OF FEATHERS. <i>Jimmie R. Parrish, David T. Rogers, Jr., and F. Prescott Ward</i>	560
CHANGES IN SONG DIALECT DISTRIBUTIONS AND MICROGEOGRAPHIC VARIATION IN SONG OF WHITE-CROWNED SPARROWS (<i>Zonotrichia leucophrys nuttalli</i>). <i>Jill M. Trainer</i>	568
THE LAYING CYCLE OF BROWN-HEADED COWBIRDS: PASSERINE CHICKENS? <i>D. M. Scott and C. Davison Ankney</i>	583
MECHANISM AND ECOLOGICAL SIGNIFICANCE OF SPERM STORAGE IN THE NORTHERN FULMAR WITH REFERENCE TO ITS OCCURRENCE IN OTHER BIRDS. <i>Scott A. Hatch</i>	593
GENETIC DETERMINATION OF PARTIAL MIGRATION IN THE EUROPEAN ROBIN (<i>Erithacus rubecula</i>). <i>Herbert Biebach</i>	601
TAXONOMY, DISTRIBUTION, AND EVOLUTION OF GOLDEN PLOVERS (<i>Pluvialis dominica</i> AND <i>Pluvialis fulva</i>). <i>Peter G. Connors</i>	607
ADDITIONS TO THE AVIFAUNA OF HONDURAS. <i>Mickey J. Marcus</i>	621
OBLIGATE AND FACULTATIVE BROOD REDUCTION IN EAGLES: AN EXAMINATION OF FACTORS THAT INFLUENCE FRATRICIDE. <i>Thomas C. Edwards, Jr. and Michael W. Collopy</i>	630
BROWN PELICAN FORAGING SUCCESS AND KLEPTOPARASITISM BY LAUGHING GULLS. <i>Gary D. Schnell, Barbara L. Woods, and Bonnie J. Ploger</i>	636
SPECIFIC STATUS AND BEHAVIOR OF <i>Cymbilaimus sanctaemariae</i> , THE BAMBOO ANTSHRIKE, FROM SOUTHWESTERN AMAZONIA. <i>Nina Pierpont and John W. Fitzpatrick</i>	645
SPATIAL PATTERNS OF YEARLING MALE BLUE GROUSE AND THEIR RELATION TO RECRUITMENT INTO THE BREEDING POPULATION. <i>Ian G. Jamieson and Fred C. Zwickel</i>	653
REPRODUCTIVE PERFORMANCE OF FEMALE-FEMALE PAIRS AND POLYGYNOUS TRIOS OF RING-BILLED GULLS. <i>Kit M. Kovacs and John P. Ryder</i>	658
EFFECTS OF EXPERIENCE AND BODY WEIGHT ON INCUBATION BEHAVIOR OF CANADA GEESE. <i>Thomas W. Aldrich and Dennis G. Raveling</i>	670
COMPETITION FOR NESTING SPACE AMONG PERUVIAN GUANO BIRDS. <i>David Cameron Duffy</i>	680
THE EFFECT OF VARIABLE SPRING WATER CONDITIONS ON MALLARD REPRODUCTION. <i>Gary L. Krapu, Albert T. Klett, and Dennis G. Jorde</i>	689
CLUTCH SIZE, REPRODUCTIVE SUCCESS, AND ORGANOCHLORINE CONTAMINANTS IN ATLANTIC COAST BLACK-CROWNED NIGHT-HERONS. <i>Thomas W. Custer, Gary L. Hensler, and T. Earl Kaiser</i>	699
FEEDING-SITE SELECTION AND FORAGING STRATEGIES OF AMERICAN WOODCOCK. <i>Dale L. Rabe, Harold H. Prince, and Donald L. Beaver</i>	711
PARASITIC EGG LAYING IN REDHEADS AND RUDDY DUCKS IN UTAH: INCIDENCE AND SUCCESS. <i>David E. Joyner</i>	717
SHORT COMMUNICATIONS	
Sex Ratio and Egg Sequence in Ring-billed Gulls. <i>John P. Ryder</i>	726
Mate changes by Black-bellied Whistling Ducks. <i>Don Delnicki</i>	728
Dump Nesting in the Wood Duck Traced by Tetracycline. <i>G. Michael Haramis, W. George Alliston, and Milo E. Richmond</i>	729
Possible Cases of Infanticide by Immigrant Females in a Group-breeding Bird. <i>Peter B. Stacey and Thomas C. Edwards, Jr.</i>	731
A Hybrid Between the Orioles <i>Icterus chrysater</i> and <i>I. mesomelas</i> . <i>Storrs L. Olson</i>	733
A Reinterpretation of Pamproctactyly in Swifts: a Convergent Grasping Mechanism in Vertebrates. <i>Charles T. Collins</i>	735
The Raising of a Ghost— <i>Spinus cucullatus</i> in Puerto Rico. <i>Herbert A. Raffaele</i>	737
A Comparison of White-bearded Manakin (<i>Manacus manacus</i>) Populations and Lek Systems in Suriname and Trinidad. <i>Deanna H. Olson and Michael K. McDowell</i>	739

Nesting of Subadult Golden Eagles in Southwestern Idaho. <i>K. Steenhof, M. N. Kochert, and J. H. Doremus</i>	743
Foraging Behavior and Success of Golden Eagles. <i>Michael W. Collopy</i>	747
Flocking in the Hook-billed Kite. <i>Dennis R. Paulson</i>	749
Tree Swallows Cross a Polygyny Threshold. <i>Terry E. Quinney</i>	750
COMMENTARY	
On the Psychology of Watching Birds: the Problem of Observer-Expectancy Bias. <i>David F. Balph and Martha Hatch Balph</i>	755
EDITORIAL	
Word Processing Versus Writing. <i>John A. Wiens</i>	758
REVIEWS. <i>Edited by William E. Southern</i>	759
NOTES AND NEWS	629, 644

NUMBER 4

PARENTAL RECOGNITION OF OFFSPRING IN THE CLIFF SWALLOW. <i>Philip K. Stoddard and Michael D. Beecher</i>	795
THE FORAGING ECOLOGY OF PERUVIAN SEABIRDS. <i>David Cameron Duffy</i>	800
THE WHITE-CROWNED SPARROW: REPRODUCTIVE SUCCESS (1975-1980). <i>Lewis Petrinoivich and Thomas L. Patterson</i>	811
ANNUAL VARIABILITY IN THE ABUNDANCE OF MIGRANT LANDBIRDS ON SOUTHEAST FARALLON ISLAND, CALIFORNIA. <i>David F. DeSante</i>	826
AN HYPOTHESIS CONCERNING THE RELATIONSHIP OF SYRINGEAL STRUCTURE TO VOCAL ABILITIES. <i>Abbot S. Gaunt</i>	853
THE PATTERN OF MIGRATION OF VILLAGE WEAVERBIRDS (<i>PLOCEUS CUCULLATUS</i>) IN SOUTHWESTERN NIGERIA. <i>A. S. Adegoke</i>	863
SPECIATION IN SAPSUCKERS (<i>SPHYRAPICUS</i>): I. GENETIC DIFFERENTIATION. <i>Ned K. Johnson and Robert M. Zink</i>	871
THE PROGRESS OF ORIOLE HYBRIDIZATION IN KANSAS. <i>J. D. Rising</i>	885
THE REACTION OF GREAT TITS (<i>PARUS MAJOR</i>) TO PLAYBACK OF DEGRADED AND UNDEGRADED SONGS: THE EFFECT OF FAMILIARITY WITH THE STIMULUS SONG TYPE. <i>Peter K. McGregor, John R. Krebs, and Laurene M. Ratcliffe</i>	898
BEHAVIOR AND TAXONOMIC STATUS OF GRAYSON'S DOVE. <i>Luis F. Baptista, William I. Boarman, and Paraskevas Kandianidis</i>	907
SEXUAL ROLES IN THE DOT-WINGED ANTWRN (<i>MICRORHOPIAS QUIXENSIS</i>), A TROPICAL FOREST PASSERINE. <i>Russell Greenberg and Judy Gradwohl</i>	920
VARIATION IN INCUBATION PERIOD WITHIN A POPULATION OF THE EUROPEAN STARLING. <i>Robert E. Ricklefs and Cynthia A. Smeraski</i>	926
FACTORS AFFECTING THE DISTRIBUTION OF MALLARDS WINTERING IN THE MISSISSIPPI ALLUVIAL VALLEY. <i>James D. Nichols, Kenneth J. Reinecke, and James E. Hines</i>	932
DOMINANCE RELATIONS, RESOURCE USE, AND PAIRING CHRONOLOGY OF GADWALLS IN WINTER. <i>Stuart L. Paulus</i>	947
NEST-SITE SELECTION BY THE RED-TAILED TROPICBIRD. <i>L. Clark, R. E. Ricklefs, and R. W. Schreiber</i>	953
FEEDING HABITATS OF NESTING WADING BIRDS: SPATIAL USE AND SOCIAL INFLUENCES. <i>R. Michael Erwin</i>	960
SHORT COMMUNICATIONS	
Formalizing the Avoidance-Image Hypothesis: Critique of an Earlier Prediction. <i>Sievert Rohwer</i>	971
Kirtland's Warbler, Victim of Its Own Rarity? <i>Harold F. Mayfield</i>	974
Basal Metabolism of the Apapane: Comparison of Freshly Caught Birds with Long-term Captives. <i>Wesley W. Weathers, Debra L. Weathers, and Charles van Riper III</i>	977
The Role of the Rhinoceros Auklet (<i>Cerorhinca monocerata</i>) in Mixed-species Feeding Assemblages of Seabirds in the Strait of Juan de Fuca, Washington. <i>Jill J. Grover and Bori L. Olla</i>	979
Notes on Common and Antillean Nighthawks of the Florida Keys. <i>Henry M. Stevenson, Eugene Eisenmann, Chester Winegarner, and Alvan Karlin</i>	983
A New Subspecies of <i>Caprimulgus cubanensis</i> (Aves: Caprimulgidae) from the Isle of Pines, Cuba. <i>Orlando H. Garrido</i> ..	988
Rediscovery of, and New Data on, <i>Molothrus armenti</i> Cabanis. <i>Armando Dugand and Eugene Eisenmann</i>	991
Lek Behavior of the Lesser Bird of Paradise. <i>Bruce Beehler</i>	992
A Dusky Warbler (<i>Phylloscopus fuscatus</i>) on Southeast Farallon Island, California. <i>Peter B. Pyle, David F. DeSante, Robert J. Boekelheide, and Robert P. Henderson</i>	995
Resting Birds Tuck Bills Toward Outside of Group. <i>Sylvia L. Halkin</i>	997

Functional Incubation in Male Barn Swallows. <i>Gregory F. Ball</i>	998
Defecation Behavior of Territorial and Nonterritorial Common Terns (<i>Sterna hirundo</i>). <i>I. C. T. Nisbet</i>	1001
COMMENTARY	
The Capitalization of Birds' Names. <i>Anselm Atkins</i>	1003
BOOK REVIEWS. <i>Edited by William E. Southern</i>	1005
NOTES AND NEWS	931, 952
ERRATA	906
INDEX TO VOLUME 100. <i>Compiled by Jean Ferner</i>	1022

SUPPLEMENTS

PROCEEDINGS OF THE ONE-HUNDREDTH STATED MEETING OF THE AMERICAN ORNITHOLOGISTS' UNION	1AA-37AA
RECENT LITERATURE	1A-35A, 1B-27B, 1C-24C, 1D-22D

DATES OF ISSUES OF "THE AUK"

VOL. 100, NO. 1—15 MARCH 1983

VOL. 100, NO. 2—22 JUNE 1983

VOL. 100, NO. 3—30 AUGUST 1983

VOL. 100, NO. 4—16 DECEMBER 1983

THE AUK

A Quarterly Journal of Ornithology

PUBLISHED BY THE AMERICAN ORNITHOLOGISTS' UNION

Editor: JOHN A. WIENS, Department of Biology, University of New Mexico, Albuquerque, New Mexico 87131

Copy Editor: JEAN FERNER

Editorial Board: WALTER BOCK, JAMES R. KING, HELMUT C. MUELLER, RICHARD L. ZUSI

Associate Editors: HERBERT W. KALE, II (Periodical Literature), WILLIAM E. SOUTHERN (Book Reviews)

THE AUK welcomes original reports dealing with the biology of birds, emphasizing the documentation, analysis, and interpretation of laboratory and field studies, theoretical or methodological developments, or reviews of existing information or ideas. Contributions are welcomed from throughout the world, but must be written in English.

SUGGESTIONS TO CONTRIBUTORS. Submit the typewritten original and two copies of the text, tables, and all other material to the editor. Three copies of illustrations should be submitted. *All typewritten material must be double-spaced on one side of numbered 8½ × 11 inch (21½ × 28 cm) good quality bond paper, with at least 1 inch (2½ cm) margins.* Originals typed on erasable, light weight, or mimeo bond will not be considered, but copies may be clear reproductions. Number pages through the Literature Cited. Avoid footnotes. The style of manuscripts should conform to general usage in recent issues. A cover page should contain the full title, a shortened version of the title (not to exceed 35 characters in length) for use as a running head, and your address at the time the research was conducted. Your present address, if different, should be given at the bottom of the first text page. The cover page should include the name and full address of the individual to whom proof is to be sent.

Each article should be preceded by an Abstract not exceeding 5% of the length of the paper. The Abstract should recapitulate the findings of the paper, not describe the work done. Acknowledgments should follow the text and precede the Literature Cited. Scientific and English names of birds always should be given where first mentioned in the text, and should follow the A.O.U. Check-list of North American Birds and supplements or the appropriate equivalent unless departures are explained and defended. SI metric units should be used in all measurements. In general, abbreviations of statistical terms and mensural units should conform with the Council of Biology Editors (CBE) Style Manual, 4th ed. Use the 24-hour clock (0800 and 2030) and "continental" dating (1 July 1971).

Tables, which must not duplicate material in either the text or illustrations, are typewritten (**double-spaced throughout!**) separately from the text. Each table should contain a short but complete heading, and must not contain vertical rulings. *Illustrations* (including labels of coordinates) should be on 8½ × 11 inch (21½ × 28 cm) sheets, and must be mailed flat. The name of the author and the figure number should be penciled on the *back* of each figure. Legends should be typed consecutively (double-spaced) on a separate page. Drawings should be drafted with undiluted india ink, and be large enough to permit ½ to ⅓ reduction to the size that they will appear in print. Graphs may be drafted on coordinate paper ruled with light *blue* lines; do *not* use coordinate paper ruled with *green* lines. Use mechanical lettering, pressure transfer letters, or calligraphy; typewritten lettering is not acceptable. Lettering should be large enough to be easily readable after 50% reduction of the figure, but not overly large. Lettering style should be uniform among all figures for a manuscript, as should the size of lettering following reduction. Photographs should be glossy prints of good contrast and sharpness, and should be approximately the same size as they will appear in print. Letters and arrows on photographs are best applied by pressure-sensitive materials. The Auk is published in a double-column format; give careful attention to designing your tables and illustrations accordingly.

Literature citations for **all** manuscripts are listed (double-spaced!) in a Literature Cited section following the text and Acknowledgments. Text citations should include author and year (e.g. Darwin 1858), or, if more than two authors are involved, the first author and year (Jones et al. 1947). If critical matter is cited or quoted directly from longer works, indicate the pertinent pages (e.g. MacArthur 1972: 204). Citations of two or more works on the same topic should be cited in chronological order (e.g. Meanley 1971, Dyer 1975). For abbreviations and forms of titles of serial publications, follow the BIOSIS List of Serials. Consult recent issues of The Auk and the CBE Style Manual for additional details.

A more detailed set of instructions for contributors appeared in the Auk, Vol. 99, No. 1 (January 1982), copies of which are available from the Editor.

ORNITHOLOGICAL MONOGRAPHS

Order from Frank R. Moore, Assistant to the Treasurer A.O.U., Department of Biology, University of Southern Mississippi, Hattiesburg, Mississippi 39406. All orders must be prepaid and include a \$0.50 handling charge. Prices to AOU members are given in parentheses.

- No. 2. *A Comparative Study of Some Social Communication Patterns in the Pelecaniformes*, by Gerard Frederick van Tets. 1965. \$3.50 (\$2.50).
- No. 3. *The Birds of Kentucky*, by Robert M. Mengel. 1965. \$15.00 (\$12.50).
- No. 6. *Adaptations for Locomotion and Feeding in the Anhinga and the Double-crested Cormorant*, by Oscar T. Owre. 1967. \$6.00 (\$4.50).
- No. 7. *A Distributional Survey of the Birds of Honduras*, by Burt L. Monroe, Jr. 1968. \$14.00 (\$11.00).
- No. 10. *The Behavior of Spotted Antbirds*, by Edwin O. Willis. 1972. \$9.00 (\$7.50).
- No. 11. *Behavior, Mimetic Songs and Song Dialects, and Relationships of the Parasitic Indigobirds (Vidua) of Africa*, by Robert B. Payne. 1973. \$12.50 (\$10.00).
- No. 12. *Intra-island Variation in the Mascarene White-eye Zosterops borbonica*, by Frank B. Gill. 1973. \$3.50 (\$2.50).
- No. 13. *Evolutionary Trends in the Neotropical Ovenbirds and Woodhewers*, by Alan Feduccia. 1973. \$3.50 (\$2.50).
- No. 14. *A Symposium on the House Sparrow (Passer domesticus) and European Tree Sparrow (P. montanus) in North America*, edited by S. Charles Kendeigh. 1973. \$6.00 (\$4.50).
- No. 15. *Functional Anatomy and Adaptive Evolution of the Feeding Apparatus in the Hawaiian Honeycreeper Genus Loxops (Drepanididae)*, by Lawrence P. Richards and Walter J. Bock. 1973. \$9.00 (\$7.50).
- No. 16. *The Red-tailed Tropicbird on Kure Atoll*, by Robert R. Fleet. 1974. \$5.50 (\$4.50).
- No. 17. *Comparative Behavior of the American Avocet and the Black-necked Stilt (Recurvirostridae)*, by Robert Bruce Hamilton. 1975. \$7.50 (\$6.00).
- No. 18. *Breeding Biology and Behavior of the Oldsquaw (Clangula hyemalis L.)*, by Robert M. Alison. 1975. \$3.50 (\$2.50).
- No. 19. *Bird Populations of Aspen Forests in Western North America*, by J. A. Douglas Flack. 1976. \$7.50 (\$6.00).
- No. 20. *Sexual Size Dimorphism in Hawks and Owls of North America*, by Noel F. R. Snyder and James W. Wiley. 1976. \$7.00 (\$6.00).
- No. 21. *Social Organization and Behavior of the Acorn Woodpecker in Central Coastal California*, by Michael H. MacRoberts and Barbara R. MacRoberts. 1976. \$7.50 (\$6.00).
- No. 22. *Maintenance Behavior and Communication in the Brown Pelican*, by Ralph W. Schreiber. viii + 78 pp., 38 text figures. 1977. Price \$6.50 (\$5.00).
- No. 23. *Species Relationships in the Avian Genus Aimophila*, by Larry L. Wolf. viii + 220 pp., 17 text figures + 10 plates, long-play phono disc album. 1977. Price \$12.00 (\$10.50).
- No. 24. *Land Bird Communities of Grand Bahama Island: The Structure and Dynamics of an Avifauna*, by John T. Emlen. xi + 129 pp., 38 text figures, appendix. 1977. Price \$9.00 (\$8.00).
- No. 25. *Systematics of Smaller Asian Night Birds Based on Voice*, by Joe T. Marshall. viii + 58 pp., frontispiece, 15 plates, phono disc supplement, appendices I-III. 1978. Price \$7.00 (\$6.00).
- No. 26. *Ecology and Behavior of the Prairie Warbler Dendroica discolor*, by Val Nolan, Jr. xx + 595 pp., color frontispiece, 42 text figures, 8 appendices. 1978. Price \$29.50.
- No. 27. *Ecology and Evolution of Lek Mating Behavior in the Long-tailed Hermit Hummingbird*, by F. Gary Stiles and Larry L. Wolf. viii + 78 pp., 26 text figures. 1979. Price \$8.50 (\$7.50).
- No. 28. *The Foraging Behavior of Mountain Bluebirds with Emphasis on Sexual Foraging Differences*, by Harry W. Power. x + 72 pp., color frontispiece, 12 text figures. 1980. Price \$8.50 (\$7.50).
- No. 29. *The Molt of Scrub Jays and Blue Jays in Florida*, by G. Thomas Bancroft and Glen E. Woolfenden. viii + 51 pp., 15 text figures. 1982. Price \$8.00 (\$6.50).
- No. 30. *Avian Incubation: Egg Temperature, Nest Humidity, and Behavioral Thermoregulation in a Hot Environment*, by Gilbert S. Grant. viii + 75 pp., 35 text figures. 1982. Price \$9.00 (\$7.00).
- No. 31. *The Native Forest Birds of Guam*, by J. Mark Jenkins. x + 61 pp., color frontispiece, 6 color plates, 24 text figures. 1983. Price \$9.00 (\$7.00).